

# 石英ガラス拡散接合

## “Quartz to Quartz Diffusion Bonding”

プレート内部に異種材料（Silicon）を封入した拡散接合品です。

It enables to create interior channel pattern inside Quartz and encapsulate Si plates.

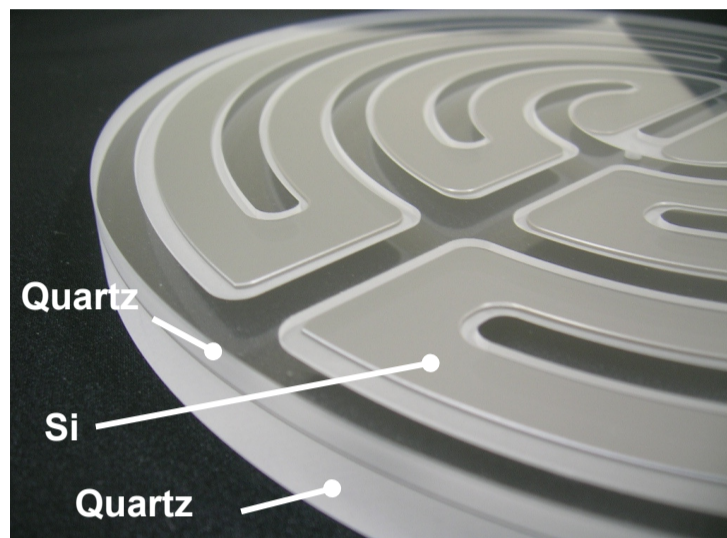

### 製品特長

### Product Features

- ▶ 母材内部に精密中空パターンを形成することが可能

It enables to create precision internal channel to Quartz substrates.

- ▶ 形状を変形させずにバルク同等の強度で接合可能

Bonding strength is equivalent with bulk material.  
No deformation.

- ▶ 製品サイズでφ500mmまで製作実績あり

Currently available with products size up to 20" in diameter.

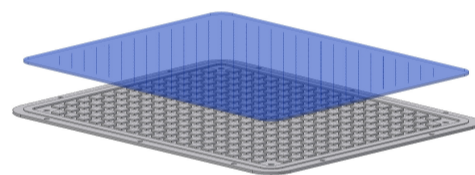

Diffusion  
Bonding

-Precision cleaning  
-Pressurization  
-Heating

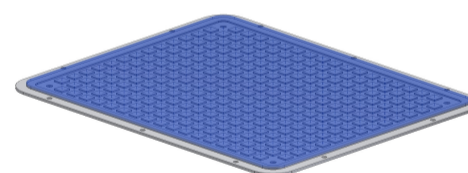

### 適用事例

### Applications

- ▶ 気体、液体を流し込む内部流路付石英（多層構造可能）

Quartz plate, with internal channel for gas or liquid flow  
(multi layer design).

- ▶ セラミックス等の異種材料の封じ込め

Containment of Ceramics or other materials.

- ▶ その他、機能部品

Other, functional components.

